

POLK COUNTY DEVELOPMENT REVIEW COMMITTEE CASE OVERVIEW

ID #: 83

DRC Date:	April 6, 2024
Planning Commission Date:	June 5, 2024
BoCC Dates:	August 6, 2024 October 1, 2024
Applicant:	David Carter, Carter and Kaye Engineering
Level of Review:	Level 4 Review, Planned Development
Case Number and Name:	LDCPAL-2024-3 CR 640 Industrial Park CPA
Request:	Change the Future Land Use designation from Phosphate Mining (PM) to Industrial (IND) on 380 +/- acres.
Location:	The subject property is located south of State Road 60, east of County Line Road, north of County Road 640, west of State Road 37, south of the city limits of Mulberry, in Sections 20 and 21, Township 30 and Range 23
Property Owner:	Mims Properties LLC, Agrifos Mining LLC, Nichols Ranch LLC
Parcel Size:	±380 +/- acres (233020-000000-014010, 233021-000000-042010, 233020-000000-011010, 233021-000000-043030)
Development Area/Overlay:	Rural Development Area (RDA)
Future Land Use:	Phosphate Mining (PM)
Nearest Municipality	Mulberry
DRC Recommendation:	Approval
Planning Commission Vote:	Approval 7-0
Case Planner:	Johnathan (JP) Sims, Planner II

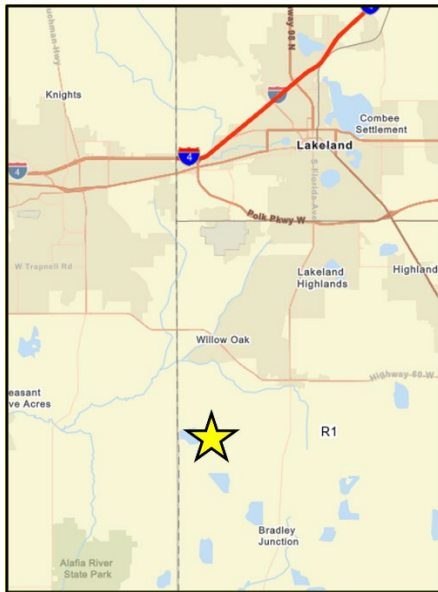

Location



Current Future Land Use